

solar^{edge}

SolarEdge Home

Load Controller

for inverters with SetApp
configuration

For Europe

V 1.4

[Datasheet](#)



[Training](#)



[Application Note](#)



- EN Quick Installation Guide
- DE Schnellinstallationsanleitung
- NL Snelle installatiegids
- FR Guide d'installation rapide
- IT Guida rapida all'installazione
- ES Guía de Instalación Rápida
- PL Skrócona instrukcja instalacji
- CZ Stručný návod k instalaci
- HU Gyors telepítési útmutató
- BR Guia de instalação rápida
- SV Snabbinstallationsguide
- SL Hitra navodila za namestitev

System Requirements and Safety Information

System Requirements

- Inverter with SolarEdge Home Network connection and CPU $\geq 4.18.xx$
- SolarEdge SetApp to connect to the inverter and upgrade firmware
- mySolarEdge to configure and read status
- iOS 10 or later or Android 6.0.1 or higher

Installation Placement Requirements

- The load controller is for indoor use only.
- To ensure correct operation, mount the Load Controller on the wall or in a cabinet.



Safety Information

- For indoor use only
- Keep children away from the device
- DO NOT use with medical or life support equipment
- DO NOT use in wet or damp area
- DO NOT clean with liquid
- Test the device locally for safe operation before attempting to control it remotely
- Use Copper conductors only
- Installation in a closed metal enclosure degrades wireless performance and must be avoided

Communication Board

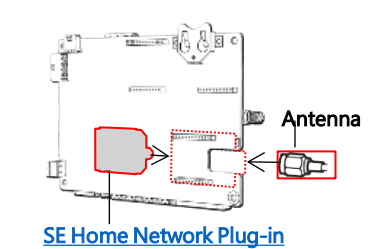

Antenna

[SE Home Network Plug-in](#)

What's in the package

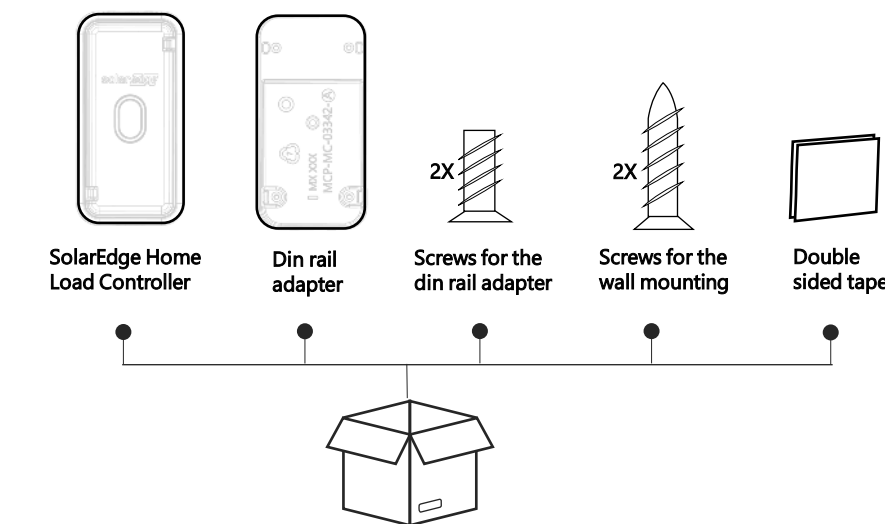

1 Mounting options

Choose one of the options below



Mount with screws

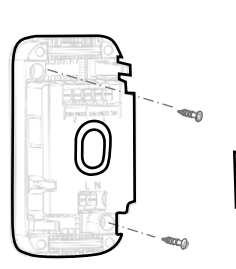

Mount with double sided tape

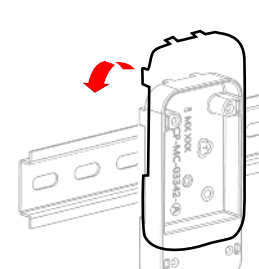

Mount with din rail adapter

IMPORTANT:
Installation is allowed at up to 2000m of altitude.

2 Cabling

Choose one of two options below

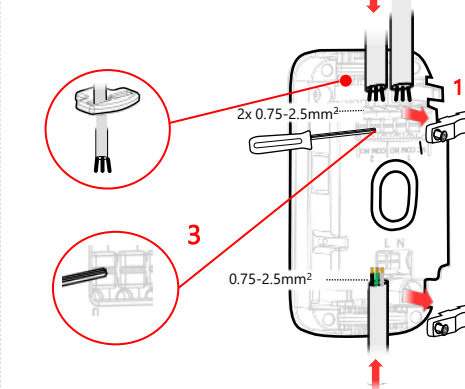

To insert cables from the top and bottom:

- Fix the cable up to 4mm² in diameter with cable rubbers.
- Pull the through the pull relief.
- Press the top connector to the conductor.

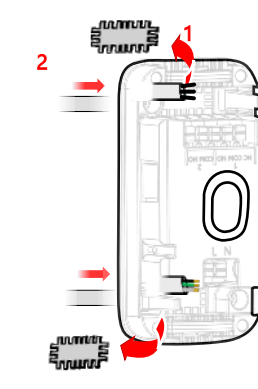

Insert cables from behind



ELECTRICAL SHOCK HAZARD

About SolarEdge

SolarEdge is a global leader in smart energy technology. By deploying world-class engineering capabilities and a relentless focus on innovation, we create smart energy products and solutions that power our lives and drive future progress.

[solaredge.com](https://www.solaredge.com)

© SolarEdge Technologies, Ltd.
All rights reserved.
Version: 1.4, August 2024
Subject to change without notice.

3

Wiring

Third Party Contactors

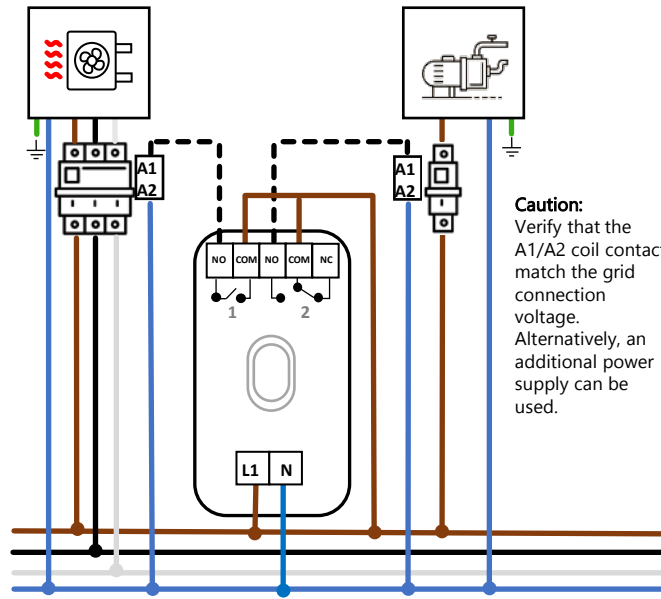

Caution: Verify that the A1/A2 coil contacts match the grid connection voltage. Alternatively, an additional power supply can be used.

SG-Ready Interface

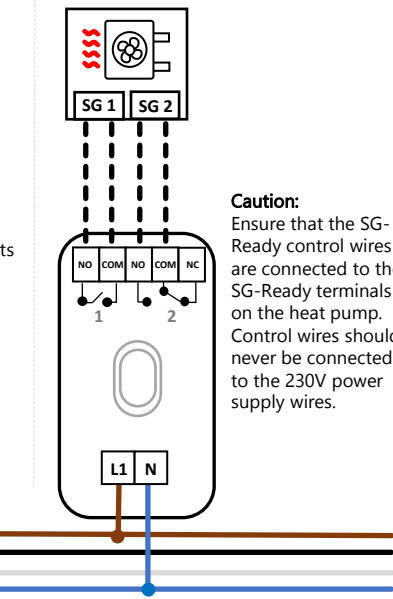

Caution: Ensure that the SG-Ready control wires are connected to the SG-Ready terminals on the heat pump. Control wires should never be connected to the 230V power supply wires.

4

Pair with inverter

1



2

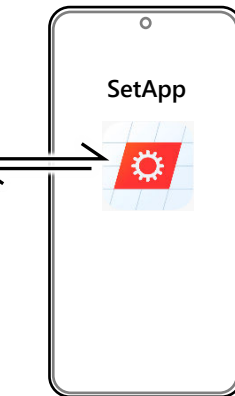

3

Commissioning

Device manager
Found new devices

Add new devices

Select devices

Add device parameters
(SG Ready only)
Select and configure two power levels

Add device

(SG Ready only)
Perform SG Ready Test

Finish settings



5

LED indications

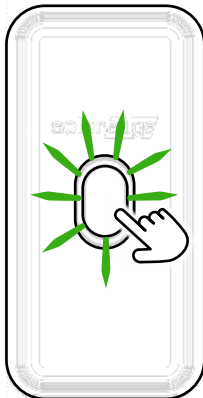

Button Operation

- Press for <3 seconds to operate manually
- Hold >10 seconds to reset

LED Indications

LED Indications	Description
Blinking Blue	Scanning for a network or connection with Home Network is lost & load off
Blinking Green	Scanning for a network or connection with Home Network is lost & load on
Blinking Blue 30 seconds	Received request of identification
Blue	Connected to Home Network & load off
Green	Connected to Home Network & load on
Blinking Red	Error
Flickering Blue	Standby
Flickering Green 5 times	Reset done

Button Operation

- If in SG Ready configuration, pressing the button switches the operation from **Auto** to **Manual** (color change **Blue** to **Green**). To switch back to **Auto**, press the button again (color change **Green** to **Blue**). In the mySolarEdge app the **Excess PV** toggle button needs to be toggled back to **Auto**.

LED Indications

- Blue LED – SG Ready operation in **Auto** mode is recommended.
- Green LED – SG Ready operation in **Manual**.

Specifications

Power	Value	Unit
AC Input Voltage	90-250	Vac
AC Frequency	50 / 60	Hz
Normally Open (NO) Contact Specifications	250 Vac up to 8 Aac / 30 Vdc up to 8 Adc	
Normally Close (NC) Contact Specifications	250 Vac up to 4 Aac / 30 Vdc up to 4 Adc	
Relay Switching Cycles	> 20,000	
Operating Hours	50,000	hr
Installation Altitude	2000	m
Power Consumption	< 1.5	W



ELECTRICAL SHOCK HAZARD
GEFAHR VON STROMSCHLÄGEN
ELEKTRISCH SCHOKGEVAAR
RISQUE DE CHOC ÉLECTRIQUE
PERICOLO DI SCOSSE ELETTRICHE
PELIGRO DE DESCARGA ELÉCTRICA



Discard this product according to local regulations or send it back to SolarEdge.

Support Contact Information

If you have technical problems concerning SolarEdge products, please contact us:
<https://www.solaredge.com/service/support>
Subject to change without notice.
Copyright © SolarEdge Inc.
All rights reserved.
December 2022.